

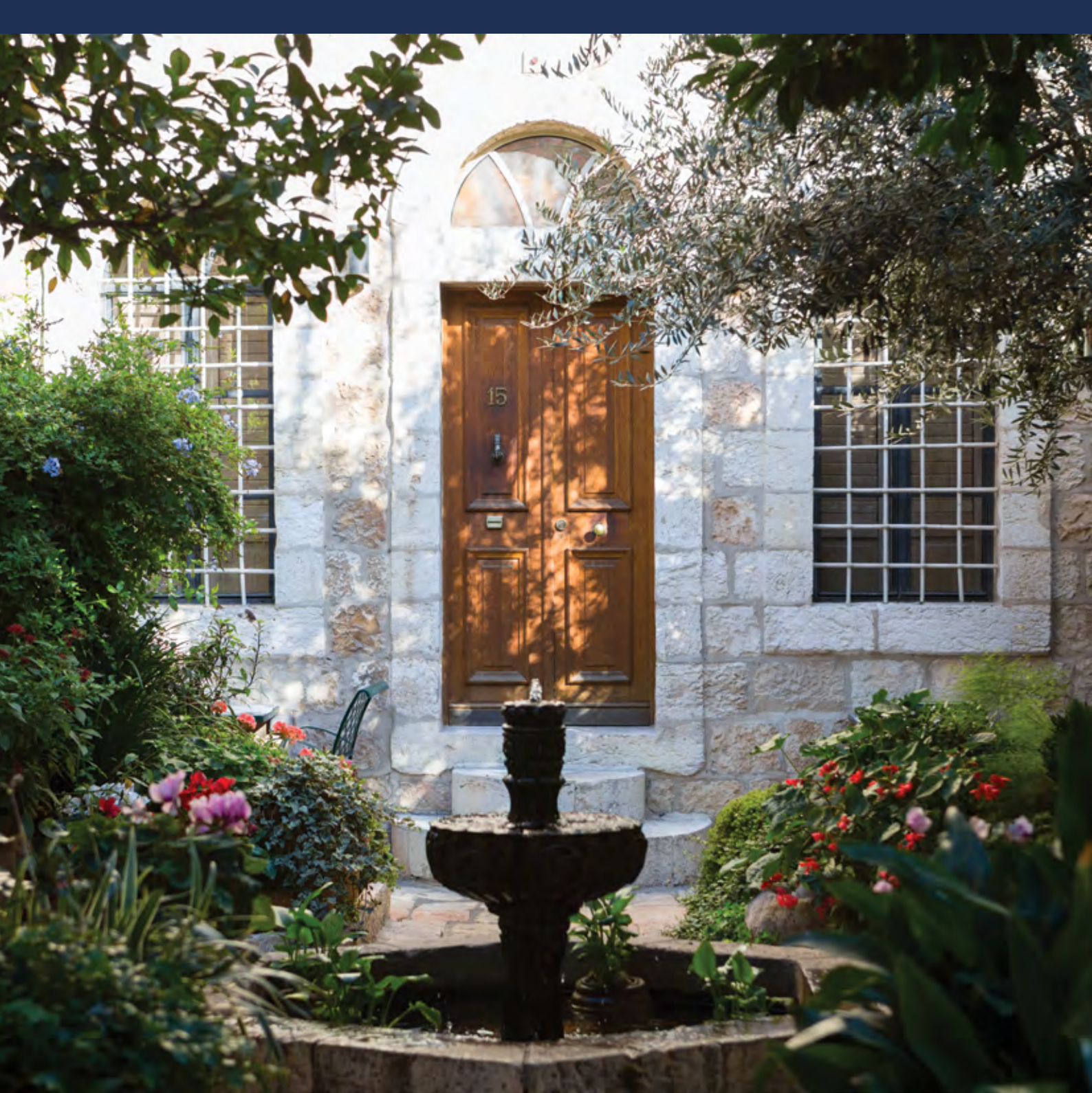

THE AMERICAN COLONY
HOTEL JERUSALEM



THE LEADING HOTELS
OF THE WORLD, LTD[®]



GAUER HOTELS
Switzerland

WELCOME

A proud member of the Leading Hotels of the World, The American Colony Hotel has been providing its luxurious hospitality services for more than 120 years.



THE BUILDINGS

The Main House: Built in the mid-19th century by Pasha El Husseini on the ruins of an older Ottoman style building. During the mid-20th century a new wing was added to meet the needs of the growing lodging demand for the American Colony Hotel.

The East House: Another of the original buildings was built circa 1870 and purchased by the Colony in 1895. It is just across from our Main House adjoining our unique edible garden.

The Palm House: Dates from the end of the nineteenth century.

The Cow Byre: Constructed by the early American Colony members, was used first as a barn, and then a forge.

BARS & RESTAURANTS

The Arabesque: The main dining room of the hotel, located in the Main House. In a gracious, traditional setting, we offer a varied menu which includes Middle Eastern and international dishes.

Val's Brasserie: Overlooking the pool and adjacent to the Cellar Bar, this informal setting provides lunch and dinner; with a warm crackling fireplace during the colder months. Enjoy local dishes and continental specialties in a cosy atmosphere. Don't miss our famous afternoon English tea.

The Courtyard: This is our most picturesque setting, famous for breakfast and romantic evening meals.

The Summer Bar: This well-known bar and barbecue, open during the summer months, is set in the tranquillity of the Palm House garden, and offers mouth-watering grilled meats and pizza from our brick oven.

The Cellar Bar: Once the American Colony dairy, this is Jerusalem's most enchanting and intimate bar. Floored with ancient pink stone, this legendary bar is a place to unwind for visitors and residents, and a popular meeting place for journalists and diplomats from across the world.

HOTEL FACILITIES & PREMISES

We provide all the amenities and facilities you have come to expect in a five star hotel.

The hotel grounds were formerly an agricultural commune, and now boasts five distinct and well-stocked gardens which are worth exploring



- Free Wi-Fi in all rooms and public areas
- Free 20 min local & international calls per day
- Free business centre
- Secretarial services
- English language newspapers
- Fitness centre
- Heated outdoor swimming pool (May – Oct)
- Dry sauna
- Massage
- Free parking on-site
- Car rental
- Transportation services
- Concierge
- Restaurants & bars
- 24/7 room service
- Lobby lounge
- Events for 10 - 250 pax with AV facilities
- Same day laundry
- Baby-sitting upon request
- Bookshop and Antiques shop



ROOMS & SUITES

The hotel consists of 92 rooms & suites.

All rooms are equipped with: air conditioning, flat screen TV with multilingual channels, mini bar, safe, bathroom amenities, bathrobes & slippers, hair dryer, work desk, coffee/tea in rooms & Nespresso machine in suites.



STANDARD

18-25 m2, 198-269 sq. ft / max 2 pax
Compact, elegant rooms; they provide a great opportunity to enjoy the unique ambience and facilities of the hotel. Located in all buildings.

CLASSIC PASHA

17-35 m2, 183-377 sq. ft / max 2 pax
Authentic and individually furnished in the Ottoman style of Jerusalem. Enjoy the period charm and modern comfort of these unique rooms. Available primarily in the Palm House.

DELUXE PASHA BALCONY/GARDEN

31-58m2, 334-624 sq. ft / max 3 pax
Located in the discrete and peaceful East House. Most rooms have a balcony or a small private garden.

COMFORT

22-29 m2, 237-312 sq. ft / max 3 pax
Cosy well-equipped rooms located primarily in the Main House, but also available in the Cow Byre. Decorated and furnished to meet the high expectations of our guests.

DELUXE PASHA

27-38 m2, 291-409 sq. ft / max 2 pax
Larger, tall rooms with arched or painted ceilings and antique-style furniture.

JUNIOR SUITE

38-76 m2, 409-818 sq. ft / max 4 pax
Exquisite larger rooms, some with original painted wooden ceilings, built by the Pasha for his wives. Main House suites open on to Courtyard, whilst others are in the Palm House and East House.

COMFORT BALCONY/POOL VIEW

29-42 m2, 312-452sq. ft / max 2 pax
Cosy well-equipped rooms located in the Main House. Decorated and furnished to meet the high expectations of our guests with either a swimming pool view or a balcony.

DELUXE PASHA POOL VIEW

29-33 m2, 312-355 sq. ft / max 2 pax
Deluxe Pasha rooms located in the Main House that have a private balcony overlooking the pool.

SUITE

38-68 m2, 506-732 sq. ft / max 3 pax
Well-appointed and luxurious, located throughout the hotel; each of these rooms has a spacious sitting area, a large bathroom and a distinct Middle Eastern character.

EVENTS & BANQUETING

Formerly a Pasha's ceremonial reception salon, The Pasha Room ceiling's central dome is one of Jerusalem's architectural masterpieces. Offering indoor seating for 100, paired with an expansive outside terrace suitable for cocktail parties.

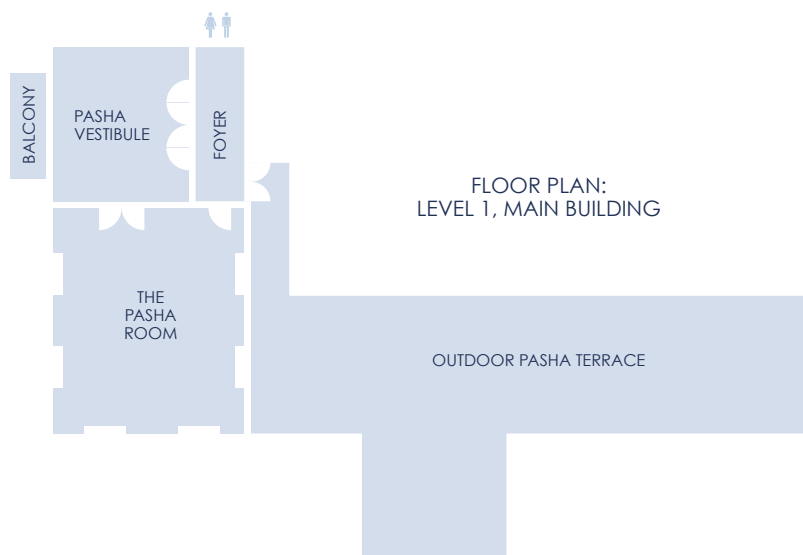

- Non-kosher catering
- Free parking
- Free Wi-Fi
- Event planning
- State of the art sound system
- HD projector
- 4 x 3 m projection screen
- Breakout areas
- Multiple lighting options
- Climate control

	Classroom	Theatre	Banquet	Reception	Conference	U-Shape	M ²
PASHA ROOM	60	100	60	150	30	30	80
PASHA TERRACE	/	/	80	200	/	/	247
PASHA VESTIBULE	/	20	/	/	15	/	30
VAL'S BRASSERIE	20	50	40	100	20	20	78
ARABESQUE	50	80	90	150	30	30	120
EXEC. MEETING ROOM	/	/	/	/	12	/	20

OUR FASCINATING HISTORY

The fire which consumed Chicago in 1871 started a series of events that would lead Horatio Spafford and his young Norwegian wife Anna to Jerusalem, and eventually to the establishment of the American Colony Hotel.



A devoutly Christian family, the Spaffords, together with sixteen other members of their church, calling themselves 'The Overcomers', journeyed to Jerusalem and settled together in a small house in the Old City.

The seeds of the American Colony as a Hotel were sown in 1902, when Baron Ustinov (grandfather of actor Sir Peter Ustinov), finding the Turkish inns of the time unacceptable, needed suitable accommodation in Jerusalem to house his visitors from Europe and America. Before long, the American Colony became a lodging for Western travellers and pilgrims whose expectations were not met by the establishments then existing in Jerusalem.

The American Colony Hotel has a unique place in the history of the area, having endured countless challenges and a series of wars. It was the venue from which the white flag - made from a bed sheet from one of the Colony's hospitals, currently displayed at the Imperial War Museum in London - was taken in 1917 to initiate the truce that ended Ottoman rule in Jerusalem. There is an archive and museum on site, where guests can browse the fascinating history of Jerusalem, the hotel, and the founders. By appointment only.



FOUNDERS & MANAGEMENT

The American Colony Hotel is still owned by descendants of the original founders. In 1980 active management of the hotel was transferred to Gauer Hotels, Switzerland.

The American Colony, a member of The Leading Hotels of the World, is famous internationally as an exceptional and unique hotel and has a global reputation for excellence, hospitality and service.

LOCATION

The American Colony Hotel is within walking distance or a short light rail journey to all of Jerusalem's major sights, and a 45 minute drive from Ben Gurion international airport.

RESERVATIONS

Ph: +972 2 6279777
Email: reserv@amcol.co.il
Web: www.americancolony.com